

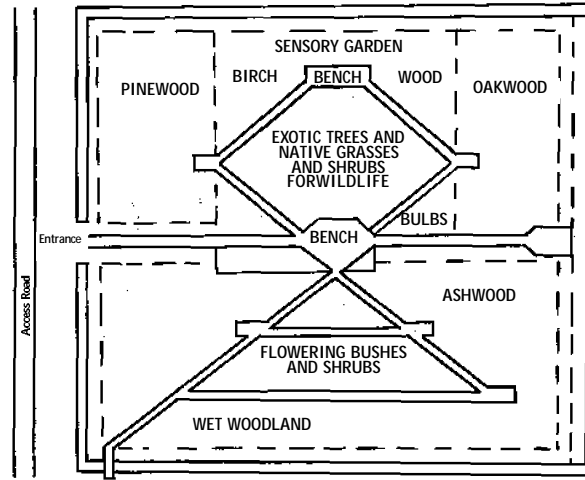

The Friends of Corstorphine Hill are turning the overgrown Hillwood Walled Garden into a Woodland Walk for the community. The aim is to allow the less physically fit to be able to appreciate the garden as a microcosm of the vegetation found on the hill, and at the same time offer educational opportunities.

The Overall Plan is to have the outer sections nearest the walls planted with swathes of native trees, such as, Pinewood, Birchwood, Ashwood and Wet Woodland. These areas will be undersown with appropriate plants. The upper central diamond shaped area is to have a few exotic trees undersown with native grasses. The lower triangular area is to be mainly shrubs.



Plan of Walled Garden

Thanks to BBC Scotland and Tern TV for inspirational advice and encouragement, and for materials and great efforts put in for the filming of the *Beechgrove Garden* in September 2001; also to the presenters Caroline Spray, Lesley Watson, Jim McColl and Carole Baxter for their help with Sensory Plants, the Wildlife Garden, Grasses and Shrubs.

Thanks also to: Edinburgh Environment Partnership Millennium Awards, Barclay's Bank, Edinburgh Biodiversity Partnership, British Trust for Conservation Volunteers, Forward Scotland, Pennant Plant Hire, JDC Contracts, Recreation Department City of Edinburgh Council.



What is still to be done?

The Walled Woodland Walk will be a continuing project. More work will be needed to finish and maintain the area. There will be planting of trees, shrubs and flowers, building walls and fences, and general maintenance. Come and join us for an hour or so and see where you could help.

Above all - be involved - it is your project.



See details on noticeboards and at the walled garden, or visit the Friends website: www.corstorphinehill.org.uk

For details contact:

Eddie Price 539 1088 or
Eddie MacIennan
539 0836 or
Les Hutcheon
334 3832.



Flower paintings by Shirley Jeffery
Garden photographs by Eddie MacIennan
Cameo photographs by David McAdam
Design by Derek Munn

©Friends of Corstorphine Hill 2001



Friends of Corstorphine Hill

Who are we?

The Friends is a group of people who have joined together to help look after the Corstorphine Hill area, for the benefit of people, animals, plants and the landscape.



What do we do?

We organise practical activities such as tidying-up and planting, improving paths and signs; we run guided walks and evening talks. Our longer-term aims include developing the old walled garden at Hillwood, and the old nursery at Beechhill, and raising funds for an education centre.



What have we done?

- Increased use for leisure and recreation
- More frequent opening of the Tower
- Improved access, tidiness and safety
- Increased understanding of the Hill
- Started on walled garden and old nursery
- Campaigned against adverse developments



What's in it for me?

- Knowing you are contributing to maintaining and improving a site of natural beauty and importance.
- Be a valued member of the community.
- Receive a regular Newsletter about the Friends.
- Receive invitations to take part in projects.
- Give advice, and attend walks and talks.

How do I join?

Membership fee is only £1 per person.

Send name, address and fee to the Chairman:

Eddie Price,
25 Corstorphine Hill Avenue,
Edinburgh, EH12 6LF

Name _____

Address _____

Postcode _____

Tel no _____

www.corstorphinehill.org.uk



Friends of Corstorphine Hill

Walled Woodland Walk



A
Community Project
for Corstorphine